

H₂O *Great Lakes Great People*

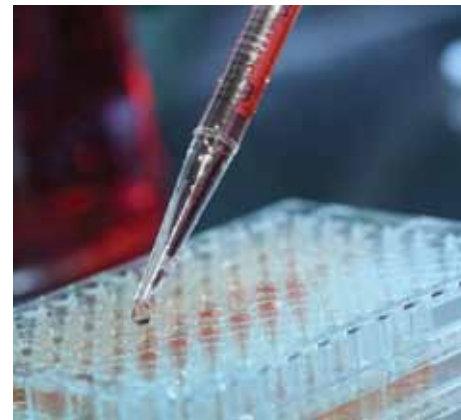

AUGUST 10-13, 2010 – SOARING EAGLE RESORT – MT. PLEASANT, MI



2010 Joint Conference

MICHIGAN SECTION – AMERICAN WATER WORKS ASSOCIATION
MICHIGAN WATER ENVIRONMENT ASSOCIATION

CONFERENCE COMMITTEE MEMBERS

Eric Way and Todd Wibright
- Conference Coordinators

Mark Coleman and
Tim Lynch
- Program Chairs

Ira Gabin and John Killips
- Exhibit Chairs

Malcolm Fox, Joe Goergen and
Nicole Spieles
- Entertainment Chairs

Eric Way, Laura Gruzowski
and Joe Keefe
- Awards Chairs

Richard Benzie and Dave Vago
- Registration Chairs

Joel Annable, Dave Timm and
Curtis Brzyski
- Golf Chairs

TABLE OF CONTENTS

MWEA President and MI-AWWA Chair's Welcome.....	3
Invited Speakers	4
General Information.....	5
Conference Schedule/CEC info/Exhibit Hall Training	6
Entertainment & Activities	7
Pre-Conference Schedule/Technical Program	8
Pre-Conference Seminar Registration Form.....	10
Joint Conference Registration Form	11
Hotel Registration Form	12
Exhibitor Contract Form.....	13
Conference Sponsor Form.....	15
Exhibitor Presentation Form	16
Golf Registration Form.....	17
MI-AWWA Committee Sign-Up Form.....	18
MWEA Committee Sign-Up Form.....	19
How to get to Soaring Eagle Resort	20

SOARING EAGLE RESORT MAP & CONFERENCE LAYOUT

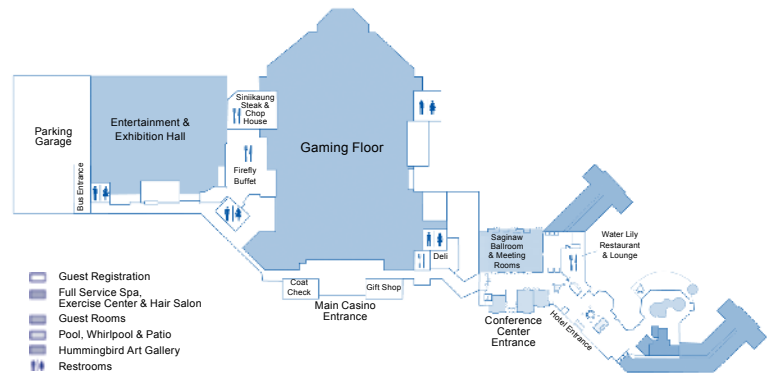
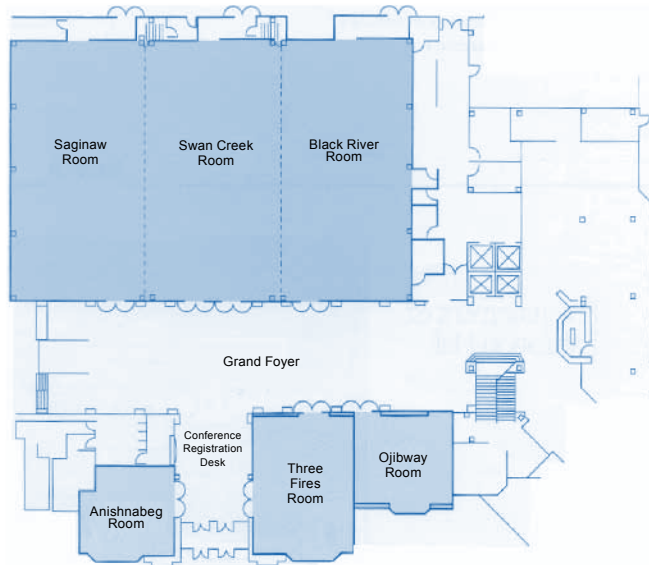

LEFT MAP: LOBBY FLOOR
BALLROOM, MEETING ROOM & PRE FUNCTION AREAS

TOP MAP: RESORT FLOOR PLAN

COME JOIN US! WON'T YOU?



TROY GALLAGHER



LARRY WOODWARD

Troy Gallagher, Section Chair of the Michigan Section/American Water Works Association, and Larry Woodward, President of the Michigan Water Environment Association, extend their most cordial invitations for all of you to join them at this year's Joint Conference. Not since 2004 in Grand Rapids have these two groups joined forces to hold a uniquely dynamic event for water professionals. Just imagine the merging of Michigan's two premier annual gatherings for the water industry. Please plan to take advantage of the diverse offerings of educational and networking opportunities.

This celebration of Michigan's finest water professionals will be held August 10-13 at the Soaring Eagle Resort and Conference Center in Mt. Pleasant, Michigan. The theme for this gathering is Great Lakes, Great People to recognize the two greatest assets of Michigan's water environment.

A quality technical program has been assembled with a focus on enhancing the knowledge base of the dedicated individuals serving the water and wastewater professions. In addition, senior level speakers from MDNRE, WEF, and AWWA will provide their unique perspectives relating to their organizations to conference attendees. The educational sessions of the conference will further offer a diverse selection of technical, personnel, and management-related training topics. The general sessions will apply to everyone in the industry and there will be breakout sessions directed at the specific disciplines represented by each of our organizations. Everyone will have ample opportunity to address their Continuing Education

Credits (CEC) needs. The technical program, along with the planned entertainment and social activities, will provide opportunities for meeting and greeting old and new friends alike.

We have received commitments from three outstanding featured speakers, Lloyd Carr, the greatly respected and successful former football coach of the University of Michigan, Jim Sygo, Deputy Director of the newly reorganized Michigan Department of Natural Resources and Environment and staunch advocate for Michigan's waters, and John McCulloch, Water Resources Commissioner for Oakland County. These three men should provide valuable insight and inspiration for all of us.

This year's event will be a hybrid of the schedule and formats of each organization's annual conferences. Please read the Conference Highlights section below carefully so as to fully understand the differences from your regular events. Be on the lookout for such items as:

- The normal AWWA daily schedule will be followed (we did MWEA's schedule in 2004).
- There will be two preconference seminars starting the morning of the first day.
- The registration fee will include three meals.
- The hotel room rate will not include any meals.
- For your convenience online registration is available.

We look forward to sharing what is destined to be an exceptionally valuable, entertaining, and memorable time with all of you. See you there!

2010-2011 MWEA BOARD NOMINATIONS

VICE PRESIDENT - Dave Vago

SECRETARY / TREASURER - Todd Wibrignt

ASSISTANT SECRETARY / TREASURER - Myron Erickson

BUSINESS MEETINGS

MI-AWWA

Thursday, August 12th at 8:00 a.m. – Ojibway Room

MWEA

Thursday, August 12th at 8:15 a.m. – Ojibway Room

CONFERENCE HIGHLIGHTS

- Online registration at www.mi-wea.org
- Pre-Conference Seminars (August 10)
- **Full Conference pricing includes 3 meals this year**
 - Dinner (Tuesday) - Awards Luncheon (Wed) - Continental Breakfast (Wed) (hotel room does not include any meals)
- 2-days of Exhibits
- Water AND Wastewater Technical Sessions
- Women's Networking / Social Hour (for Women Conference Attendees Only – sorry, not a spouse event)
- AWWA Young Professionals and MWEA New Professionals Networking / Social Event
- Keynote Guest Speaker - Jim Sygo, Deputy Director - MDNRE
- Featured Speaker – John McCulloch, Water Resources Commissioner - Oakland County
- Special Guest Speaker and Picture Opportunity with Lloyd Carr, Former U of M Football Coach
- Attendee and Guest Activities (Bike Ride, Golf Outing, Canoe Trip)
- Awards Luncheon
- Annual Banquet

SPECIAL GUEST SPEAKER



LLOYD H. CARR

ASSOCIATE ATHLETIC DIRECTOR AND FORMER
HEAD FOOTBALL COACH UNIVERSITY OF
MICHIGAN – ATHLETICS

Lloyd Carr became Associate Athletic Director in 2008 after completing his 13-year career as Michigan's head football coach with a victory over No. 9 Florida in the 2008 Capital One Bowl. Carr compiled a 122-40 overall record during his career. He guided U-M to the 1997 national championship and five Big Ten Conference crowns.

A member of the Wolverine football staff for 28 years, Carr served 15 years under Bo Schembechler (1980-89) and Gary Moeller (1990-94) initially as defensive secondary coach, became the defensive coordinator, and then moved into the position of assistant head coach before becoming head coach in 1995.

Beyond the football field, Carr has been involved in many charitable causes. He has endowed a women's athletics scholarship, initiated the Women's Football Academy and U-M Men's Fantasy Football Experience which benefit the University of Michigan Comprehensive Cancer Center, and the "Carr Wash for Kids" to benefit the University of Michigan C.S. Mott Children's and Women's Hospital. He also serves as a spokesperson for Mentor Michigan to help recruit men and women to help children in



need. He is involved with local charities such as the Ann Arbor Symphony Orchestra, Shelter Association of Washtenaw County, Washtenaw Literacy and United Way and annually hosts the Hall-of-Fame football camp in his home town of Riverview.

Carr began his coaching career as a high school assistant at Nativity High in Detroit (1968-69) and at Belleville (Michigan) High School from 1970-73. He was head coach at John Glenn High School (Westland, Michigan) from 1973-75, earning Regional Class A Coach of the Year honors in 1975. His collegiate coaching career started with two seasons at Eastern Michigan (1976-77), followed by two seasons at Illinois (1978-79) before arriving at the U-M.

He graduated from Northern Michigan University 1968 with a B.S. in education and a Master's in education administration in 1970. He received an honorary degree from Albion College in 2008.

Carr has received numerous accolades and awards including being inducted into multiple Halls of Fame and receiving various coaching honors, including the 1997 National Coach of the Year, the Bobby Dodd Coach of the Year, and others from the Walter Camp Football Foundation, American Football Coaches Association, Football News, Maxwell Football Club, Woody Hayes, the Paul "Bear" Bryant, the R. R. Neyland Memorial Award from the Knoxville Quarterback Club and the Philip Hart Public Service Award and the Dodge National Athletic Lifetime Achievement Award.

Lloyd and his wife Laurie have six children and 11 grandchildren.

KEYNOTE SPEAKERS



JIM J. SYGO

MICHIGAN DEPARTMENT OF NATURAL RESOURCES
AND ENVIRONMENT DEPUTY DIRECTOR

Jim J. Sygo was appointed Deputy Director of Environmental Protection in the newly created Department of Natural Resources and Environment in January 2010. As Deputy Director, he has oversight of the Air Quality Division, Groundwater Division, and Remediation Division. He was most recently the Deputy Director of the Department of Environmental Quality since May 25, 2003, with oversight of the Water Bureau, Land and Water Management Division, Waste and Hazardous Materials Division, Air Quality Division, Remediation and Redevelopment Division, Office of Geological Survey, and Office of Pollution Prevention and Compliance Assistance. Prior to that he was the Division Chief of the Remediation and Redevelopment Division and, prior to the department's reorganization in September 2002, he was the Division Chief of the Waste Management Division. As Division Chief, he has administered the statewide programs for the cleanup of contaminated sites and for the management of hazardous waste, solid waste, liquid industrial waste, pollution incident plans, and groundwater discharges.

Sygo has been with the Department of Natural Resources and Environment (formerly the Department of Environmental Quality [DEQ]) since becoming a water quality specialist in the Saginaw District in 1983. He was named Saginaw District Supervisor of

Waste Management Division programs in 1987, Region II Waste Management Supervisor in Roscommon in 1989, and Region III Waste Management Supervisor for the southern half of the Lower Peninsula in 1990.

Sygo, has a bachelor's degree from the University of Michigan in meteorology and oceanography and a master's degree in oceanography also from U of M. He worked for the Department of State Police as a health physicist before joining the DEQ. Prior to joining the State Police, Sygo worked for Spicer Engineering in Saginaw, and Black and Veatch in Detroit as a consultant and as a water quality management planner for the East Central Michigan Planning and Development Region.



JOHN MCCULLOCH

OAKLAND COUNTY WATER
RESOURCES COMMISSIONER

John McCulloch served for 10 years as a member of the Oakland County Board of Commissioners prior to being elected Drain Commissioner in 2001. His title changed to Water Resources Commissioner in November, 2008. He was Chairman of the Board of Commissioners for five years and served for eight years on the Drainage Board. An attorney and certified public accountant, Commissioner McCulloch has authored numerous articles on water quality that have appeared in both national and international journals and publications.

GENERAL INFORMATION

JOINT CONFERENCE REGISTRATION

All conference participants including attendees, spouse/guests, speakers, exhibitors, and award recipients are required to register for the conference. The Conference Registration Form can be found on page 11 of this brochure. For the easiest and fastest method of registration, we encourage you to REGISTER ONLINE at www.mi-wea.org. MWEA will process all the registrations this year – please do not call AWWA for any registration questions or inquiries. You can reach MWEA by calling 517-641-7377 or emailing mwea@mi-wea.org.

PRE-CONFERENCE SEMINAR REGISTRATION

This year we are offering 2 seminars that will take place simultaneously on Tuesday, August 10th before the start of the Joint Conference. The seminars being offered are #1: Asset Management and Financial Management and #2: Green Maintenance. Both start at 9:00am. Registration for these is separate from the registration for the Joint Conference. If you would like to attend one of the Pre-Conference Seminars AND the Joint Conference, you must register for BOTH. You can register online at www.mi-wea.org or register by mail or fax.

CONFERENCE FEES

FULL CONFERENCE REGISTRATION includes:

- Tuesday night Exhibits, Dinner, and Lloyd Carr Presentation/photos
- Wednesday Continental Breakfast in Exhibit Hall
- Wednesday Awards Luncheon in Exhibit Hall
- ALL Technical Sessions (Wed-Fri)

The Full Conference Registration DOES NOT include the Annual Banquet on Thursday evening. For other conference fees, refer to the Conference Registration Form on page 11 of this brochure.

MEALS

Refer to the Conference Registration form on page 11 of this brochure to see what meals are paid for with your registration fee. You will receive either a meal ticket /or wristband for some meals. Be sure to bring or wear them when required.

NAME BADGES

Name badges must be worn at all times and are required for entrance to ALL conference sessions, meals and activities.

GOLF

The golf outing will take place at two different Golf Courses: Bucks Run and the PohlCat. Please check in at the Conference Registration Desk to find out which course you are “assigned” to or call MWEA at (517) 641-7377 prior to August 9th. To register for the golf outing, either register online at www.mi-wea.org or fill out the Golf Registration Form on page 17 of this brochure. If you would like to sponsor a hole at the golf outing, please refer to the same Golf Registration Form.

EXHIBIT PRESENTATIONS

There will be 30-minute presentations that will take place in various exhibitor’s booths. These presentations are free of charge, but you must be a conference attendee to receive the .05 CEC’s for attending each presentation. More information about these presentations will be in the Conference Guide that you will receive at registration.

PAYMENT

Checks, MasterCard, Visa and American Express will be accepted for registration. Cash payments and onsite registration are available but discouraged.

CONFERENCE ATTIRE

The suggested conference attire is ‘business casual.’ The exception to this is Thursday evening’s Annual Banquet which is ‘business formal’.

HOTEL ACCOMMODATIONS

The hotel accommodations are not part of your registration fee. To receive the Joint Conference Rate, hotel reservations must be made directly with the Soaring Eagle by July 19, 2010. Reservations made after the room block is filled, are not guaranteed the special rate. Hotel accommodations can be made by faxing the Hotel Form found on page 12, directly to the Soaring Eagle at Fax #989-775-5686. This fax number is also located on the Hotel Form.

PLEASE DO NOT SEND THE HOTEL FORM TO MWEA.

CHECK IN/CHECK OUT

Check in time at the Soaring Eagle is 4:00pm. Check out time is 11:00am.

REFUNDS/CANCELLATIONS

If cancelled by July 10, you will receive a full refund. If cancelled by July 31, you will receive a 75% refund. If cancelled after July 31 or you do not show for the conference, you will not be entitled to a refund. For Hotel Room refunds, refer to the Hotel Form on page 12.

QUESTIONS

If you have questions please contact the MWEA Office at 517-641-7377 or send an email to mwea@mi-wea.org.

CONFERENCE SCHEDULE

MONDAY, AUGUST 9, 2010	
3:00 p.m. - 8:00 p.m.	Exhibitor Move In Entertainment Hall
TUESDAY, AUGUST 10, 2010	
7:00 a.m. - 12:00 p.m.	Exhibitor Move In Entertainment Hall
7:30 a.m. - 2:00 p.m.	Conference & Pre-Conference Registration Conference Registration Desk
9:00 a.m. - 1:30 p.m.	Pre-Conference Seminars / Lunch Black River / Swan Creek Rooms
2:00 p.m. - 7:00 p.m.	Conference Registration Entertainment Hall Registration Desk
2:00 p.m. - 9:00 p.m.	Vendor Exhibits Entertainment Hall
3:00 p.m. - 4:00 p.m.	Women's Networking Event (for women conference attendees only) Entertainment Hall
4:00 p.m.	Best Tasting Water Contest Entertainment Hall
5:00 p.m.	5-S Meeting 3 Fires Room
6:00 p.m. - 8:00 p.m.	Dinner Entertainment Hall
7:00 p.m.	Meet and take pictures w/ Lloyd Carr Entertainment Hall
8:00 p.m.	Lloyd Carr Presentation Entertainment Hall
WEDNESDAY, AUGUST 11, 2010	
7:30 a.m. - 12:00 p.m.	Conference Registration Registration Desk
7:30 a.m. - 8:30 a.m.	Continental Breakfast Entertainment Hall
7:30 a.m. - 3:00 p.m.	Vendor Exhibits Entertainment Hall
8:30 a.m. - 11:45 p.m.	Opening Session Saginaw/Swan Creek/Black River Rooms
12:00 p.m. - 2:00 p.m.	Awards Luncheon Entertainment Hall
2:00 p.m. - 5:00 p.m.	Conference Registration Registration Desk
2:00 p.m. - 5:00 p.m.	Wastewater Session 1 Saginaw Room
2:00 p.m. - 5:00 p.m.	Drinking Water Session 2 Swan Creek Room
2:00 p.m. - 5:00 p.m.	WW / DW Session 3 Black River Room
5:30 p.m. - 7:00 p.m.	New Prof./Young Prof. Event 3 Fires Room
5:30 p.m. - 8:00 p.m.	Bike Ride (departs at 6pm) Main Hotel Lobby

THURSDAY, AUGUST 12, 2010	
7:00 a.m. - 8:00 a.m.	MDNRE Breakfast 3 Fires
7:30 a.m. - 12:00 p.m.	Conference Registration Registration Desk
8:00 a.m. - 8:15 a.m.	AWWA Business Meeting Ojibway Room
8:15 a.m. - 8:30 a.m.	MWEA Business Meeting Ojibway Room
8:30 a.m. - 11:00 a.m.	Wastewater Session 4 Saginaw Room
8:30 a.m. - 11:00 a.m.	Drinking Water Session 5 Swan Creek Room
8:30 a.m. - 11:00 a.m.	WW / DW Session 6 Black River Room
12:00 p.m. - 6:00 p.m.	Golf Outing Bucks Run or PohlCat Golf Course
12:30 p.m. - 6:00 p.m.	Canoe Trip (departs at 1pm) Main Hotel Lobby
5:30 p.m. - 6:30 p.m.	Reception and MWEA 5S Induction Saginaw/Swan Creek/Black River Rooms
6:30 p.m. - 9:30 p.m.	Annual Banquet Saginaw/Swan Creek/Black River Rooms
FRIDAY, AUGUST 13, 2010	
7:00 a.m. - 8:15 a.m.	MWEA Committee Chair Breakfast 7th Floor
8:15 a.m. - 9:45 a.m.	Wastewater Session 7 3 Fires Room
8:15 a.m. - 9:45 a.m.	Drinking Water Session 8 Ojibway Room
8:15 a.m. - 9:45 a.m.	WW / DW Session 9 Saginaw Room
10:00 a.m. - 12:00 p.m.	Plenary Session Saginaw Room

CONTINUING EDUCATION CREDITS

Individuals holding a DNRE (formerly DEQ) Drinking Water/ or Wastewater Operator Certification will be eligible to receive:

- 0.3 CECs (management category) for attending one of the Pre-Conference Seminars
- Up to 1.2 CECs for attending the Technical Sessions
- Up to 0.3 CECs for attending the Exhibit Hall Training
- 0.1 CEC for attending one day of the exhibits

EXHIBIT HALL TRAINING

Exhibit Hall training will be offered on Tuesday and Wednesday. These will be informal hands-on 30 minute training sessions at an exhibitor's booth. Individuals attending any of the 30-minute sessions will receive 0.05 CECs for each session, up to a maximum of 0.3 CECs. There is no additional cost to attend these sessions, but you must be a paid conference registrant. Go to the MWEA website at www.mi-wea.org or the MI-AWWA website at www.mi-water.org for updated information about what training is being offered at the booths.

ENTERTAINMENT & ACTIVITIES

2ND ANNUAL WOMEN'S NETWORKING EVENT

TUESDAY, AUGUST 10TH • 3PM - 4PM - EXHIBITS HALL

AWWA and MWEA cordially invite you to join us for Chocolate & Coffee at the 2nd Annual Women's Networking Event on Tuesday, August 10 from 3pm to 4pm in the Exhibit Hall. This event is for Women Conference Registrants Only. Sorry, it is NOT a spouse event. There is no cost to attend, but you must check the "Women's Networking Box" on the Conference Registration Form to attend. This event will help you to:

- Gain insights
- Build your professional network
- Rethink goals
- Resolve to meet challenges
- Renew your enthusiasm

If you have any questions or would like more information please contact Christine Spitzley at (517) 393-0342.

SILENT AUCTION TO BENEFIT SAFE WATER IN ECUADOR

TUESDAY, AUGUST 10TH DURING EXHIBITS

The AWWA *Safe Water in Ecuador* Committee will again be hosting a silent auction. This is an opportunity to bid on some fun and interesting items. All proceeds raised will go toward supplies for a Potable Water Project in Ecuador. The committee is once again looking for items to be donated to this great cause. Past donations have included big ticket items like Bicycles, MP3 Players, Computers and T.V.s. But the auction is also in need of items like vacation packages, skiing certificates, massage gift certificates, gift baskets, visa gift cards or gas cards. **New this year is a contest for the most creative Gift Basket entry.** You could make a Coffee/Tea Basket, Chocolate Lovers Basket, or a Golf Enthusiast Basket - the possibilities are endless! The *Safe Water in Ecuador* Committee will be voting on their favorite Gift Basket and the winning person/organization will win the honor of "Most Creative Donation". Please submit your auction donation item description to Deb Bailey at pcvdebb@gmail.com by August 1, 2010. Please consider donating all you can to this year's auction and we look forward to seeing you in Mt. Pleasant in August.

WATER FOR PEOPLE BIKE RIDE

WEDNESDAY, AUGUST 11TH • 5:30PM

Bring your own Bike and join us for a Bike Ride to benefit Water For People. This 24 mile, 2 hour ride, will take you on paved trails from the Pere Marquette Rail Trail to the Chippewa Trail. Participants can ride a shorter distance if they choose and the ride is open to everyone, even if you don't register for the conference. The cost is a \$15 donation to Water For People and includes an "all you can eat" ice cream stop along the way. Contact Gary DeKock at gdekock@grcity.us in advance if you plan to attend or for any other questions. The day of the ride, Gary can be reached at 616-648-3021.

Note: Weather conditions may prevent the ride from taking place. For safety reasons, all riders MUST wear helmets. All participants should meet in the lobby no later than 6pm and be ready to leave promptly at 6:00pm. Riders will be back to the Soaring Eagle by 10pm.

JOINT CONFERENCE MIXER

Sponsored by the AWWA Young Professionals & MWEA New Professionals

WEDNESDAY, AUGUST 11TH • 5:30PM - 7PM - 3 FIRES ROOM

Join us for appetizers, drinks & networking in the 3 Fires Room! You must be a Conference Registrant to attend this event. Pre-register by checking the box at the bottom of the Conference Registration Form.

WATER FOR PEOPLE CANOE TRIP

THURSDAY, AUGUST 12TH • 12:30PM

Join us for a 2 ½ hour Canoe Trip down the beautiful Chippewa River. The cost of the trip is \$55 and includes the canoe rental provided by Chippewa River Outfitters located at 3763 S. Lincoln Rd in Mt. Pleasant. The cost also includes a \$19 donation to Water For People and an "All you can eat" chocolate chip cookie break at the midpoint of the trip. Contact Gary DeKock at gdekock@grcity.us by July 1st if you plan to attend. Later registrations will be considered but no guarantee of canoe availability can be made. The day of the event, Gary can be reached at 616-648-3021.



Note: Weather conditions may prevent the trip from taking place and unfortunately, refunds are not available. All participants should meet in the lobby no later than 1pm and be ready to leave promptly at 1:00pm. Canoeists will be back to the Soaring Eagle by 6pm and in time for the 6:30 Banquet.

THE 2010 JOINT CONFERENCE GOLF OUTING

THURSDAY, AUGUST 12TH • 12PM

The AWWA's *Safe Water in Ecuador* committee is sponsoring this year's conference golf outing, which will take place on Thursday, August 12, 2010. The outing is a great opportunity to raise funds for our water supply projects in Ecuador. We would like your firm to sponsor a hole this year.

Through past support of AWWA and MWEA members and associates, we have been able to help pay for construction of twelve water supply systems in Ecuador. These Quichua villages, located in the Andes Mountains, now have clean water supplies to replace untreated open ditch water.

Safe Water in Ecuador is currently working with Bruce Rydbeck, our partner in Ecuador, to select another community in which to construct a water supply. Money raised at the golf outing will be used for this new project. As in the past, the villagers are providing all the labor.

Show your support of the efforts for *Safe Water in Ecuador* by making a contribution of \$250 to sponsor a golf hole at the 2010 Joint Conference Golf Outing. See Golf Registration Form on page 17 of this brochure.

BEST TASTING WATER CONTEST

Sponsored by the MI-AWWA

TUESDAY, AUGUST 12TH • 4PM - EXHIBITS HALL

Every year since 1985, the Michigan Section conducts an annual taste contest for municipal water supplies. The Spring Regional Winners will meet at the Joint Conference to determine the winner for the year. Judging for this event begins Tuesday, August 10th at 4pm in the Exhibits Hall. Please come root for your favorite water supply and see if they win. The winner may be eligible to represent the Michigan Section at the AWWA Annual Conference and Exposition in Washington DC and compete with section winners from the US and Canada.

Attention Spring Regional Winners: You may enter the competition held at the Joint Conference by providing a quart mason jar filled with treated water. Contestants should arrive an hour early to allow their sample to reach room temperature. For more information, contact Gary Wozniak at wozniakg@michigan.gov or (269) 567-3613.

PRE-CONFERENCE SEMINARS

TUESDAY, AUGUST 10TH AT 9:00AM

We are pleased to announce that there will be 2 Pre-Conference seminars offered on Tuesday, August 10, 2010. Registration for the seminars is completely separate from the registration for the Joint Conference. If you would like to attend a Pre-Conference Seminar AND the Joint Conference, you must register for BOTH.

PRE-CONFERENCE SEMINAR #1: "ASSET MANAGEMENT AND FINANCIAL MANAGEMENT – BRIDGING THE GAP"

Aging infrastructure is a well known challenge that needs to be accounted for, financed, planned, understood and communicated. This seminar will help you make the connection from the boots on the street to the value of the service provided. Not only will you get a straight forward approach to asset management and financial management, but you will also learn how financial planning can help make asset management a reality.

9:00 a.m.	Registration Black River Room (coffee/rolls provided)
9:30 a.m.	Asset Management & Financial Planning John Julien, Umbaugh
10:15 a.m.	Rate Setting to Support Asset Management Westing Engineering
11:00 a.m.	How to Present Your Message to Your Stakeholders Charles Fleetham, Project Innovations
11:45 a.m.	Lunch (provided)
12:30 p.m.	Case Study – Using Asset Management Techniques in the Development of a Capital Improvement Program David Vago, Wade Trim & Tim Prince, Oakland County
1:15 p.m.	Questions & Answers

PRE-CONFERENCE SEMINAR #2: "GREEN MAINTENANCE"

This seminar will help you to use common sense, proven practices, and new technologies in implementing a maintenance program that is effective, efficient, and ecologically friendly. This seminar is intended for maintenance personnel, managers, superintendents, engineers, plant operators and other personnel involved in budget making decisions.

9:00 a.m.	Registration Swan Creek Room (coffee/rolls provided)
9:30 a.m.	Electrical Equipment Maintenance Affects Efficiency Ken Colston, YCUA
10:15 a.m.	Load Balancing and Power Factor Ken Colston, YCUA
11:00 a.m.	Process Changes, Equipment Changes, Cost Savings Ken Colston, YCUA
11:45 a.m.	Lunch (provided)
12:30 p.m.	Recycling and Universal Waste Programs Ken Colston, YCUA
1:15 p.m.	Questions & Answers

TECHNICAL PROGRAM

OPENING SESSION - WEDNESDAY SAGINAW / SWAN CREEK / BLACK RIVER ROOMS

8:30 a.m.	Welcome Troy Gallagher, Larry Woodard • MI-AWWA / MWEA
8:45 a.m.	Keynote Guest Speaker Address Jim Sygo • MDNRE
9:30 a.m.	WEF Representative • Water Environment Federation
10:15 a.m.	BREAK
10:30 a.m.	H2 Opportunities, Collaborative Asset Management - A Dual Approach to Cost Savings John McCullough • Featured Speaker, Oakland County Water Resources Commissioner
11:15 a.m.	AWWA Representative • AWWA

SESSION 1 WEDNESDAY - WASTEWATER TREATMENT TECHNOLOGIES. SAGINAW ROOM

2:00 p.m.	Strategy for Containing and Treating Groundwater Contaminated by Landfill Leachate Barbara Marczak, Joe Hebert • Prein & Newhof
2:30 p.m.	Odor Control Without Chemicals Mark Prein • Prein & Newhof
3:00 p.m.	Deer Lake Mercury Settlement Steve Casey • MDNRE
3:30 p.m.	Evaluation of Filtration Technologies - Cadillac Walid Al-Ani • Stantec
4:00 p.m.	Disposable Nets with Disinfection Mirza Rabbaig, Imad Salim • DWSD
4:30 p.m.	Constructed Wetlands Treatment of an Industry's Wastewater Art Kuljian • Tetra Tech

SESSION 2 WEDNESDAY - DRINKING WATER TREATMENT TECHNOLOGIES. SWAN CREEK ROOM

2:00 p.m.	MI First Lime Softening to RO Softening Conversion Project Ray Berkin • City of Allegan and Trevor Wagenmaker • Prein and Newhof
2:30 p.m.	Modeling to Manage Water Nitrate in Bloomington, IL Dan Haddock • Layne Christensen
3:00 p.m.	Saginaw's "Virtual Fence" Security System Gene Jones, Paul Reinsch • City of Saginaw
3:30 p.m.	Exploring On-Site Chlorine Generation for Municipal Facilities Anne Heyt • OMM Engineering
4:00 p.m.	Case Study: New Rapid Sand Filters at Donald K Shine WTP Ben Whitehead • Black & Veatch
4:30 p.m.	Arsenic / Iron Co-Precipitation & High Rate Filtration in City of Portage Daniel Starkey, Christopher Barnes • AECOM

**SESSION 3
WEDNESDAY - UTILITY MANAGEMENT.
BLACK RIVER ROOM**

2:00 p.m.	What COPS Means to Your Facility <i>Vincent Plansky • CDM</i>
2:30 p.m.	Sewers: A Source of Municipal Liability Under CERCLA <i>Richard Baron, Brian Phinney, Marc Lawrence • Foley, Baron, Metzger</i>
3:00 p.m.	Protecting Your Water Supply & Your Bottom Line: Shifting Costs from Ratepayers to Polluters <i>Alexander Leff • Sher Leff LLP</i>
3:30 p.m.	Managing Utility During a Recessionary Period <i>John Julien • UMBAUGH</i>
4:00 p.m.	Progressive Storm Water Ordinance - DeWitt <i>Kevin Feuka, Susan Erickson • C2AE</i>
4:30 p.m.	What you don't know can hurt you <i>Tom Armstrong • ARCADIS</i>

**SESSION 4
THURSDAY - WASTEWATER ENERGY MANAGEMENT.
SAGINAW ROOM**

8:30 a.m.	Effective Turndown of Aeration Air Prime Movers for Energy Savings <i>Randy Rogers • CDM</i>
9:00 a.m.	Between a Rock Bluff and Hard Place - Petoskey Bay Harbor <i>Dennis Benoit • HRC</i>
9:30 a.m.	Increased Energy Efficiency - Allegan WWTP <i>Doug Sweeris & Ray Berkin • City of Allegan, Trevor Wagenmaker • Prein and Newhof</i>
10:00 a.m.	Benchmarking: Setting and Measuring Energy Conservation <i>Vic Smith • Greeley and Hansen</i>
10:30 a.m.	Innovative Tools for Energy Savings in Municipal WWTP <i>Tom Allbaugh • Tetra Tech</i>

**SESSION 5
THURSDAY - DRINKING WATER TREATMENT.
SWAN CREEK ROOM**

8:30 a.m.	Sand Migrations Cause Intake Improvements- Michigan City, Indiana <i>Randall Russell • Dept of Water Works</i>
9:00 a.m.	Putting HERO in Customer Service <i>Carrie Lee • Herndon Solutions</i>
9:30 a.m.	Public Water Testing, Certification and Verification Programs <i>C Bruce Bartley • NSF</i>
10:00 a.m.	ISO's Public Protection Classification <i>Stanley Diamond • Greeley & Hansen</i>
10:30 a.m.	The Culture of Asset Management <i>Dave Vago • Wade Trim, Dave Mason • IMG</i>

**SESSION 6
THURSDAY - MANAGING THE WORKPLACE.
BLACK RIVER ROOM**

8:30 a.m.	When Corporations and Community Work Together - Success? <i>Ed Mahaney, Dave Vago • Wade Trim</i>
9:00 a.m.	Training Issues & Challenges - Case Studies Using Online Training <i>Todd Raish • 360 Water</i>
9:30 a.m.	Enforcement: Why You Should Do Your Own Reporting <i>Adrienne Nemura • Limno Tech</i>
10:00 a.m.	Employee Involvement - Keys to Success of VPP Implementation <i>Kanwer Khan • United Water</i>
10:30 a.m.	AWWA's New Customer Service Certificate Program <i>Tom DeLaura • Westin Engineering</i>

**SESSION 7
FRIDAY - COLLECTION SYSTEM INNOVATIONS.
3 FIRES ROOM**

8:15 a.m.	Evaluation of Private Property I/I Sources for Sanitary Sewer Eval Study <i>Jay Zawacki • CDM</i>
8:45 a.m.	Don't Rehab - Renew - Waterford's Sewage PS <i>Terry Biederman, Greg Gucwa • Waterford Twp</i>
9:15 a.m.	Sustaining a CMOM Program in the City of Novi <i>Micheele LaRose • OHM Advisors</i>
9:45 a.m.	BREAK

**SESSION 8
FRIDAY - DRINKING WATER DISTRIBUTION.
OJIBWAY ROOM**

8:15 a.m.	HDPE Case Study: Pipe Bursting in Livonia <i>Bruce Kuffer • Plastics Pipe Institute</i>
8:45 a.m.	Diurnal Water Use & Implications for Master Planning <i>Janice Skadsen • CDM</i>
9:15 a.m.	Historic Stand Pipe Rehab - Sault Ste. Marie <i>Ira Gabin • Dixon Engineering</i>
9:45 a.m.	BREAK

**SESSION 9
FRIDAY - SYSTEM MANAGEMENT.
SAGINAW ROOM**

8:15 a.m.	Water Conservation Impacts on Water Rates <i>James Burton • Hubbell, Roth & Clark</i>
8:45 a.m.	Floodplains and Your Treatment Plant <i>Dan Schechter • Greeley & Hansen</i>
9:15 a.m.	System-Wide Process Controls Update at the DWSD <i>P J Dada • DWSD</i>
9:45 a.m.	BREAK

**CLOSING SESSION - FRIDAY
SAGINAW ROOM**

10:00 a.m.	Dan Wolz Award Winners
10:30 a.m.	Safe Water in Ecuador Update
10:45 a.m.	MDNRE Update
11:15 a.m.	News from the Field <i>Steve Aiken • Stantec and MI-AWWA Young Professionals Committee</i>

2010 MI-AWWA / MWEA PRE-CONFERENCE SEMINAR REGISTRATION



For fast and easy registration, register online at www.mi-wea.org or fill out the information below and fax to 517-641-7388

Name: _____

Company/Employer: _____

Street Address: _____

City: _____ State _____ Zip _____

Daytime Phone: _____

*Email: _____

*Registration confirmations are sent via email address only

SEMINAR CHOICE

Each seminar is worth 0.3 CEC's for Drinking Water and Wastewater in the "management" category. Attendance at the exhibits following the seminar will earn an additional 0.1 CEC's in the "other" category.

Conference #1: Asset Management and Financial Management

OR

Conference #2: Green Maintenance

CONFERENCE PRICING

\$85 – AWWA, MWEA or WEF Members – Member Number: _____

\$95 – Non-Members

PAYMENT

Check Enclosed (make out to MWEA and send to: PO Box 397 - Bath MI - 48808)

Charge to my: VISA MasterCard American Express

For Credit Card Payments Only:

Credit Card # _____ Expiration Date _____

Billing Name: _____

Billing Address: _____

Billing City: _____ State _____ Zip _____

Signature: _____

2010 JOINT CONFERENCE REGISTRATION FORM

Register online at www.mi-wea.org or fill out the information below and fax to 517-641-7388

MI-AWWA Member #: _____ or MWEA Member #: _____

Name (for Badge): _____

Company Name: _____

Street Address: _____

City: _____ State _____ Zip _____

Phone: _____

*Email: _____ *Registration confirmations sent via email address only

Name(s) of Family Member/Guest Attending: _____

REGISTRATION OPTIONS	Member		Non-Member	
	By July 15	After July 15	By July 15	After July 15
Full Conference (Tuesday – Friday) Includes: Exhibits, Dinner, Lloyd Carr (Tues) - All Technical Sessions (Wed-Fri), - Exhibits, Continental Breakfast, Awards Luncheon (Wed). DOES NOT INCLUDE THURSDAY NIGHT BANQUET – SEE BELOW	\$315	\$365	\$390	\$440
Tues/Wed Conference Only Includes: Exhibits, Dinner, Lloyd Carr (Tues) - Technical Sessions, Exhibits, Continental Breakfast, Awards Luncheon (Wed)	\$250	\$300	\$325	\$375
Thurs/Friday Conference Only Includes: Thursday & Friday Technical Sessions only. DOES NOT INCLUDE MEALS – SEE BELOW	\$175	\$225	\$250	\$300
Speaker – Speaking Day Only Includes: Technical Sessions on the day you are speaking. DOES NOT INCLUDE MEALS – SEE MEALS BELOW. Note: Speakers who are attending more than their speaking day must register for one of the options above.	\$0	\$0	\$0	\$0
Retirees with Spouse-Attending the Awards Lunch Only Includes: Awards Luncheon (Wed) for Retiree & Spouse	\$0	\$0	\$0	\$0
Retirees with Spouse-Attending Full Conference Includes: Exhibits, Dinner, Lloyd Carr (Tues)- All Technical Sessions (Wed-Fri), -Exhibits, Continental Breakfast, Awards Luncheon (Wed) for Retiree or Retiree & Spouse DOES NOT INCLUDE THURSDAY NIGHT BANQUET – SEE BELOW	\$50	\$50	\$50	\$50
Total				\$

EXTRA MEALS NOT INCLUDED WITH REGISTRATION FEE AND MEALS FOR SPOUSES & GUESTS		# of tickets	Cost per ticket	Total
Tuesday	Exhibits/Dinner		\$35	\$
Tuesday	Women's Networking (for female paid attendees only – this is NOT a spouse event)		\$0	\$
Wednesday	Awards Luncheon (Award Recipients are FREE)		\$25	\$
Wednesday	New Professional/Young Professional Event (for paid attendees only)		\$0	\$
Thursday	Banquet *Banquet is not included in the Conference Price. PLEASE SELECT MEAL PREFERENCE (# _____ OF CHICKEN MEALS # _____ OF BEEF MEALS)		\$35	\$
Total				\$

PAYMENT **GRAND TOTAL** \$

Charge to my: VISA MasterCard American Express

Credit Card #: _____ Expiration Date: _____

Billing Name: _____

Billing Address: _____

Billing City: _____ State: _____ Zip: _____

Signature: _____ Send a copy of this form with payment to: MWEA, PO Box 397 Bath MI 48808

CANCELLATION POLICY

If cancelled by July 10, you will receive a full refund. If cancelled by July 31, you will receive a 75% refund. If cancelled after July 31 or you do not show for the conference, you will not be entitled to a refund.

2010 JOINT CONFERENCE HOTEL FORM

ROOM BLOCK: MONDAY, AUGUST 9, 2010 - FRIDAY, AUGUST 13, 2010

To reserve your overnight accommodations or modify an existing reservation, [please complete this form or fax or mail it by July 19, 2010.](#) (PHONE RESERVATIONS WILL NOT BE ACCEPTED.) to: Soaring Eagle Casino and Resort, 6800 Soaring Eagle Boulevard, Mt. Pleasant, MI 48858, Attention: Room Reservations, Fax: (989) 755-5686. Please print your information clearly. You may also reserve accommodations at www.soaringeaglecasino.com. Reserve Your Room Here, Group Code: 96070D. For prompt confirmation, please completely fill out form.,

Name of guest(s) occupying room: _____

Street Address: _____

City: _____ State: _____ Zip: _____

Phone: _____ Fax: _____

==Player's Club Number: _____ Email: _____

Please list the room type you would prefer (Please mark 1st and 2nd choice)

Smoking and Non-Smoking rooms are available, however, we cannot guarantee which type you will receive. We will do our best to accommodate all of your requests. ****Rates quoted are per night.** MEALS ARE NOT INCLUDED WITH ROOM.**

(\$139.00) First Class Room - 1 King Bed (\$139.00) First Class Room - 2 Queen Beds

There will be a \$10.00 per person charge nightly for the third and fourth person in a room over the age of 6.

All rates are subject to a Tribal tax. If this reservation is being paid for by tax exempt organization funds, then, a copy of the Sales Tax Exemption Certificate form #700, generated by the Saginaw Chippewa Indian Tribe (SCIT), must be sent at the time with the accompanying reservation form. Form #700 must be in the organization's name. For information on how to apply for tax exemption with the SCIT, please visit our website www.soaringeaglecasino.com under Hotel Conference Center. Tax exempt reservations cannot be paid for with personal funds. Tax exempt status must be resolved 72 hours prior to the day of arrival.

With the following requests:

Smoking Non-Smoking Barrier Free Room Hearing Accessible Room

How many adults in room: _____ How many children: _____ Ages: _____

All reservations must be guaranteed with a deposit; either a check or credit card for one night's lodging along with this form. If you are using a credit card, your card will be charged for the deposit at the time this reservation is made.

BILLING INFORMATION

Charge to my: VISA MasterCard American Express

Credit Card #: _____ Expiration Date: _____

Bill Credit Card for all nights? Yes No, 1st night only

Billing Name: _____

Signature: _____

You will receive a confirmation letter within 7-10 business days at the address listed above. If you would like your confirmation letter faxed to you instead, please list the appropriate fax number and check the box next to it. You should receive your faxed confirmation letter within 72 hours.

Please make sure your reservation request reaches the Resort by the date listed above to apply for a room that is held by the Group Block. After the date listed above, or should the Group Block be filled, rooms will be reserved based on availability. Group rates cannot be guaranteed. Reservations cancelled by 6:00p.m., 3 days prior to arrival, will receive a full refund.

Check-In time is after 4:00 p.m. Check-Out time is 11:00 a.m.

*****Please, One (1) room reservation per Group Reservation Request Form.**

ANNUAL CONFERENCE EXHIBITOR CONTRACT

EXHIBIT DATES ARE AUGUST 10 - 11, 2010

Register ONLINE at www.mi-wea.org or fill out the information below and fax to 517-641-7388. This represents a contract between the undersigned and the MI-AWWA and MWEA.

Company: _____

Contact Name: _____ Title: _____

Mailing Address: _____

City, State, Zip: _____

Phone Number: _____ Fax: _____

*Email: _____ *Registration confirmations sent via email address only

Brief description of product or service: _____

INCLUDED WITH BOOTH PRICE

The Exhibit Fee includes standard booth equipment (see below) and ONE FULL Conference Registration**. It does not include lodging, other meals, or activities. The price for each additional Exhibitor at your booth includes Tuesday dinner, Wednesday Continental Breakfast and Wednesday Awards Luncheon. The extra exhibitor price does not include a Full Conference Registration and is not required if the extra exhibitor will be registering for a Full Conference Registration.

** FULL Conference Registration includes Tuesday dinner, Wednesday Continental Breakfast and Wednesday Awards Luncheon and all technical sessions.

EXHIBIT REGISTRATION

\$600 for 1 booth paid in full by June 1, 2010

\$700 for 1 booth paid in full AFTER June 1, 2010

\$1,000 for 2 booths paid in full by June 1, 2010

\$1,100 for 2 booths paid in full AFTER June 1, 2010

Number of Additional Exhibitors at your booth _____ @ \$100 Each

For more information for more than 2 booths, call MWEA at 517-641-7377

ADDITIONAL MEALS NOT INCLUDED WITH REGISTRATION FEE AND MEALS FOR SPOUSES & GUESTS		# of tickets	Cost per ticket	Total
Tuesday	Women's Networking (for female paid attendees only – this is NOT a spouse event)		\$0	\$
Wednesday	Awards Luncheon		\$25	\$
Thursday	Banquet *Banquet is not included in the Conference Price.		\$35	\$
TOTAL FOR EXHIBIT REGISTRATION				\$

EXHIBITOR NAMES

Fill in the names of your representatives as they should appear on their name badge (Please print):

Name: _____ Name: _____

Name: _____ Name: _____

For forms or online registration go to www.mi-wea.org. Booth space will not be reserved until the exhibit fee is paid in full. Hotel Reservations are handled by the Soaring Eagle. Hotel Reservation Form should be faxed directly to the Soaring Eagle for processing.

See www.mi-wea.org for more information.

AGREEMENT

I hereby contract to participate in the 2010 Joint Conference Vendor Event and agree to pay the appropriate Exhibit fee, as explained above. I agree to all of the terms of the "Liability and Responsibility Clause" which is a part of this contract.

Authorized by: _____ Company: _____

Signature: _____ Date: _____

ANNUAL CONFERENCE EXHIBITOR CONTRACT CONT'D

PAYMENT

Check (payable to MWEA) Amount\$: _____ Check #: _____

Charge to my: VISA MasterCard American Express Amount \$: _____

Credit Card #: _____ Expiration Date: _____

Billing Name: _____

Billing Address (City, St, Zip): _____

Phone: _____ Signature: _____

Register online at www.mi-wea.org or send payment and contract to: MWEA PO Box 397 Bath, MI 48808 Fax (517) 641-7388

STANDARD BOOTH EQUIPMENT

- 8' x 10' Exhibit Booth space
- Exhibit booth draping with 8' high backs and 3' high sides
- One covered and skirted 2' x 6' display table
- Two chairs
- Electrical Outlet
- One waste basket

For details on modifications to the Standard Booth Equipment, see the Art Craft Display information below.

LIABILITY AND RESPONSIBILITY CLAUSE

In signing the Exhibitor's Contract, the Exhibitor agrees to assume total responsibility and liability for losses, damages, and claims arising out of injury or damage the exhibitor's displays, equipment, and other property brought upon the premises of the exhibit site; and shall indemnify and hold harmless the MI-AWWA and MWEA and the conference site host facility and the agents, servants, and employees of each organization, for any and all such losses, damages, and claims.

MI-AWWA and MWEA abides by all the music licensing organizations' (ASCAP, BMI, etc.) requirements. You are responsible for securing the appropriate license(s), for any and all music played at your booth during the vendor show.

SETUP TIMES & EXHIBIT HOURS

SETUP TIMES:

Monday, August 9: 3pm-8pm
Tuesday, August 10: 7am-Noon

EXHIBIT TIMES:

Tuesday, August 10: 2pm-9pm
Wednesday, August 11: 7:30am-3pm

DEAR EXHIBITOR:

Art Craft Display, Inc. has been selected by your show management to serve as your official exposition service contractor for this event.

Your exhibitor kit for this event is available on-line. If you do not have internet access, art craft display can fax or mail the kit by calling (616) 791-8024. If you need additional equipment or services, you can download order forms using the following procedures:

Go to the following website: www.artcraftdisplay.com

Click on: "Get Exhibitor Kit"

Enter Event Code: 153722

ADVANCE ORDER DEADLINE IS FRIDAY, JULY 30, 2010, 5:00 PM.

If we can be of any further assistance, please contact us. We are looking forward to being of service to you.

Yours for better show service,

ART CRAFT DISPLAY, INC.

(616) 791-8024

ANNUAL CONFERENCE SPONSOR CONTRACT FORM

Register online at www.mi-wea.org or fill out the information below and fax to 517-641-7388.
This represents a contact between the undersigned company and the MI-AWWA and MWEA.

Make the most of your company's investment by participating as a conference sponsor. As a sponsor, your firm will be listed in the Daily Program and in the MWEA magazine, *Matters*. Signs recognizing sponsors will be prominently displayed at various times and locations throughout the Conference. Your company will also be showcased in a continuous-loop PowerPoint presentation displayed during Exhibitor Night.

MWEA ANNUAL CONFERENCE SPONSORSHIP OPPORTUNITIES

Bronze (\$300) Your Company's Name or Logo displayed on a sign board and 1 PowerPoint slide.

Silver (\$500) Your Company's Name or Logo displayed on a sign board and 2 PowerPoint slides

Gold (\$800) Your Company's Name or Logo displayed on a sign board, 3 PowerPoint slides, and a dinner ticket for the Banquet on Thursday evening.

Platinum (\$1,000) Your Company's Name or Logo displayed on an individual sign board, 4 PowerPoint slides, your logo prominently placed on the front cover of the Daily Activities Guide, a dinner ticket for the Banquet on Thursday evening and one Full Conference Registration.

E-mail slides OR large files on CD to the MWEA office. Slides submitted after August 1, 2010 will not be included in the presentation.
MWEA, PO Box 397, Bath MI 48808 or mwea@mi-wea.org

SPONSORSHIP LEVELS

Bronze Level - \$300 Silver Level - \$500 Gold Level - \$800 Platinum Level - \$1000

Company: _____

Contact Name: _____

Address: _____

City: _____ State: _____ Zip: _____

Phone Number: _____ Fax: _____

E-Mail: _____

PAYMENT

Check (enclosed) Visa MasterCard American Express

Credit Card Number: _____ Expiration Date: _____

Billing Address: _____

Billing City: _____ State: _____ Zip: _____

Signature: _____

CONFERENCE SPONSORS

Thank you to the following companies for their generous support of this year's conference (as of the print date of this brochure):

Black & Veatch
DuBois Cooper Associates, Inc.
Greeley and Hansen, LLC
Limno Tech, Inc.
Pumps Plus, Inc.
Wade Trim
Westin Engineering of Michigan

ANNUAL CONFERENCE EXHIBIT PRESENTATIONS

Abstracts are being sought for presentations to be given at vendor booths on Tuesday, August 10th or Wednesday, August 11th, 2010. The presentations should be 30 minutes in length and be "hands-on" training for O & M type items. Topics are requested for the following presentation categories:

- People (Including recruiting, retention, training/education, safety.)
- Energy Management
- Instrumentation and Controls
- Personnel Management
- Regulatory Issues
- Customer Service
- Laboratory Practices
- Treatment Innovations
- Operations and Maintenance
- Water Resources Management

- Presenters must be a registered exhibitor to participate.
- There are no additional costs to being an Exhibit Presenter
- Presenters shall provide a brief (one page or less) written abstract summarizing their talk.
The abstract shall include the presentation title along with other requested information listed below.
- Presentations shall be 20 to 25 minutes in length, and allow 5 minutes for questions and answers.
- The Michigan Section AWWA and MWEA Exhibit Committee will review all abstracts.
The corresponding author of each abstract will be notified of the acceptance or rejection of the proposed paper by July 1st, 2010.
- There is no limit to the number of abstracts that may be submitted by an individual or company/utility.
- Membership in AWWA or MWEA is not required for presentation.

PRESENTATION INFORMATION

Presentation Title: _____

Has this Presentation been given previously? Yes No

If Yes, When & Where?: _____

Presentation Category: _____

Presenter's Name: _____

Title: _____

Company/Utility: _____

Address: _____

Phone Number: _____ Fax: _____

E-Mail: _____

If you are submitting an abstract on behalf of someone else, i.e., colleague, student, etc., please provide YOUR information below.

Name: _____

Title: _____

Company/Utility: _____

Address: _____

Phone Number: _____ Fax: _____

E-Mail: _____

Please attach one (1) page abstract to this form and send to the following by June 1, 2010.

Karlyn Wickham
Michigan Water Environment Association
PO Box 397
Bath, MI 48808
karlyn@mi-wea.org
517-641-7377

MI-AWWA/MWEA GOLF OUTING

THURSDAY, AUGUST 12, 2010 GOLF SCRAMBLE, \$85 PER PERSON

This year's Golf Outing will take place at both the *Bucks Run* and *PohlCat Golf Courses* on Thursday, August 12, 2010 with a shotgun start at 12:00pm. You will be assigned your course at a later date and will be notified by email or phone prior to August 7th. The event will be a 4-person scramble with prizes awarded at both courses to the winning teams. In addition, there will be special prizes for the longest drive and closest to the pin. Pre-payment is required. The cost for this event is \$85.00 per person which includes 18 holes, golf cart, range balls, prizes and lunch. Check in at the pro shop of the course you are playing on, no later than 11:30am. Registration is on a first-come, first-serve basis. Space is limited, so register early. To find out which course you will be playing on, call the MWEA office after August 1, or check at the Conference Registration desk when you arrive. Registration for the Golf Outing is separate from registration for the Joint Conference. If you would like to attend the Golf Outing and Conference you must register for both.

FIREMAN'S ROPE

MWEA will be offering each foursome the opportunity to purchase a 'fireman's rope' for \$20. These must be purchased the day of the event, prior to the start. Proceeds from the Rope Sale go to benefit the MWEA Student Scholarship Fund.

PUTTING CONTEST

MI-AWWA will be doing a Putting Contest for \$5 per person. The proceeds from the Putting Contest will go for support of Safe Water in Ecuador.

SKINS CONTEST

At each course you will have the option of entering your team in the Skins Contest. Cost per team is \$20.00.

GOLFER REGISTRATION INFORMATION

Register online at www.mi-wea.org or fill out the information below and fax to 517-641-7388

Contact Name: _____

Company: _____

Mailing Address: _____

City, State, Zip: _____

Phone Number: _____ Fax: _____

*Email: _____ *Registration confirmations sent via email address only

Please register the following person(s) for the Golf Outing. \$85 per person is due at the time of registration. If you do not have a foursome, you will be put in a foursome with other people.

Person #1: _____

Person #2: _____

Person #3: _____

Person #4: _____

GOLF SPONSORS - \$250 / HOLE

If you would like to sponsor a hole, please check this box (\$250 / hole). Hole Sponsors will get their Company Name/or Logo on each of the holes sponsored. All proceeds will go for support of Safe Water in Ecuador.

\$85 x _____ (# of golfers) = \$: _____

Hole Sponsorship (\$250 / Hole) = \$: _____

Total Amount Enclosed = \$: _____

PAYMENT

Charge to my: VISA MasterCard American Express

Credit Card #: _____ Expiration Date: _____

Billing Name: _____

Billing Address: _____

Billing City: _____ State: _____ Zip: _____

Signature: _____

MI-AWWA SECTION COMMITTEE SIGN-UP FORM

Contact Name: _____

Company: _____

Mailing Address: _____

City, State, Zip: _____

Phone Number: _____ Fax: _____

Email: _____

STANDING COMMITTEES (INDICATE 1ST, 2ND, 3RD CHOICES)

Please check the committee(s) in which you have an interest and indicate 1st, 2nd and 3rd choices. You will be contacted by the Committee Chair.

- | | | |
|---|--|-------------------------------------|
| Asset and Infrastructure Management | Laboratory Practices | Small Community Water Systems |
| Community Awareness | Maintenance | Source Water Protection |
| Conference Program | Management/ Administrative Practices | Tapping Contest |
| Conference Registration | Manufacturer's Advisory | UP Coordinating |
| Communications | Membership | Water Efficiency/Conservation |
| Customer Satisfaction | Mentoring | Water System Security |
| Distribution Practices | MIWARN | Water Treatment Practices |
| Education | Operators' Day | Water Utility |
| Faust Scholarship Award | Planning/CQI | Young Professionals |
| Groundwater | Research/Tech Practices | Youth Education |
| Historical Preservation | Safe Water in Ecuador | |
| Joint Expo | Safety Practices | |

- I am interested in serving on the committee(s) indicated above
- I am looking for suggestions for a committee on which to serve.

HOPE TO SEE YOU AT THE SOARING EAGLE RESORT & CONFERENCE CENTER

Return completed form to:
 Michigan Section, AWWA
 P.O. Box 16337
 Lansing, MI 48901-6337
 or Fax: 517-241-0325



MWEA COMMITTEES

YOUR OPPORTUNITY TO GET INVOLVED

Please indicate (✓) the committee(s) you would like to join

Joining a committee is the very best way of getting the most out of your MWEA membership. As with so many things, "What you get out of it, depends on what you put into it." The committees are the lifeblood of the organization and they offer opportunities that are often unavailable to us through our employer: Networking, Demonstrating (or learning) leadership skills, Earning esteem from peers, Feeling good about contributing to our society, and most of all, Having fun. Joining is easy. Just give us your contact information and check a box.

STANDING COMMITTEES MISSION STATEMENTS

- Asset & Infrastructure Management:** To bring awareness of the subject, common understanding, practical, usable tools and assistance to work with organizations to implement successful Asset Management programs in both plant and linear environments.
- Biosolids:** To provide leadership and promote beneficial uses of Biosolids.
Vision: To make Michigan a national leader in environmentally sound Biosolids processes and products.
- Certification/Education:** Provide for the Education and Voluntary Certification of wastewater plant staff.
- Collection Systems:** To provide a forum for the ongoing education of operators, managers engineers, and technical sales professionals within the State of Michigan on wastewater collection systems construction, operation, maintenance, and management.
- Decentralized Wastewater:** To increase awareness that water quality is directly linked to the use of appropriate wastewater systems and their management.
- Government Affairs:** review and analyze legislation, administrative policies, rules and regulations pertaining to the water environment. Develop the Association's position on issues for public presentation and industry seminars in accord with MWEA objectives.
- Groundwater:** collect, review, interpret and disseminate literature pertaining to the treatment of industrial type wastewater prior to discharge into municipal sewers and control programs dealing with such discharges. Offer training and educational opportunities for MWEA members.
- Health & Safety:** Dedicated to the education of wastewater industry professionals and the evaluation and recognition of sound Health and Safety Practices throughout the water, wastewater, and associated professions.
- Industrial Pretreatment & Industrial Waste:** Promote effective implementation and administration of Industrial Pretreatment Programs and Industrial Waste Treatment through the sharing of information, education, and training, and the recognition of professionalism through certification.
- Information Management & Technology:** To promote the use and understanding of computers and computer related technology as it impacts the water and wastewater industries.
- Joint Expo:** To plan for and conduct a two-day joint Operator's Day program and expo with Michigan Section AWWA.
- Laboratory Practices:** To enhance professional expertise in environmental laboratories through information, education, training, and encouragement of analyst certification to promote accurate and precise measurements of Michigan waters.
- Lagoon Operators:** To keep Lagoon Wastewater Treatment Plant Superintendents and Operators apprised of new MDEQ regulatory changes as well as new lagoon process technologies and equipment available in the wastewater industry.
- Local Sections:** To encourage participation by the exchange of ideas assisting in the revitalization of inactive Sections and conduct Annual Regional Meetings.
- Maintenance:** disseminate literature, information, and conduct maintenance-related training pertaining to the maintenance of wastewater treatment, collection, and control system.
- Operations Challenge:** To conduct an annual Operations Challenge competition to select at least one "team" to represent MWEA for the Challenge at WEFTEC.
- Process:** provide operator-training opportunities directly related to Wastewater Treatment Plant Process operation, monitoring, optimization and control.
- Public Education:** responsible for the development, recommendation, and presentation of public education designed to enhance the public's understanding of water environment issues.

- Student Activities:** To provide services and programs to encourage student involvement in the water environment field (both the Clean Water & Drinking Water industries).
- Wastewater Administrators:** To provide education and training opportunities to those water quality professionals who are responsible for administering water quality effort.
- Watershed Management:** To provide leadership on Watershed Management policy, practice, and education.

AD HOC COMMITTEES MISSION STATEMENTS

- Environmental Management Systems:** To bring together a diverse group of professionals to provide a forum for information exchange that relates to the understanding development and implementation of environmental management systems for the clean water industry.
- New Professionals:** Designed to provide new professionals and new members with an opportunity to maximize their potential as professionals in the water environment field.
- Storm Water Utility:** To aid communities wishing to establish storm water utilities for stormwater and watershed management.
- Water For People:** To help people in Developing countries improve their quality of life by supporting the development of locally sustainable drinking water resources, sanitation facilities and health and hygiene education programs.
- Wolz Memorial:** To manage the Wolz Memorial Fund and to select award winners.

MANAGEMENT COMMITTEES MISSION STATEMENTS

- Awards:** To select final nominees for all Association and Federation awards.
- Constitution & Bylaws:** To prepare all proposed amendments to the Constitution & Bylaws and/or receive and review proposed amendments by others.
- Entertainment:** To develop the Annual Conference entertainment program, including social and competitive activities.
- Exhibits:** To organize the activities associated with the Annual Conference exhibits.
- Membership:** promote and encourage Association membership. Actively recruit new members while maintaining current members. Create tools and systems for membership recruitment and retention activities.
- Nominations:** To nominate candidates for each office of the Board of Directors.
- Program:** To develop the technical program for the Annual Conference.
- Strategic Planning:** To develop a long-range plan for the Association.

I am interested in serving on the committees indicated.

I am looking for suggestion for a committee on which to serve.

Name: _____

Address1: _____

Address2: _____

Phone: _____

E-mail: _____

Signature _____

If you are unsure about what committee to join, simply ask for someone to contact you, and we will be glad to help.

MAIL TO:
MWEA – P.O. Box 397 Bath, MI 48808
(ph) 517-641-7377 (fx) 517-641-7388 mwea@mi-wea.org



MI-AWWA/MWEA Joint Conference | August 10-13, 2010

CONFERENCE LOCATION:

6800 E. SOARING EAGLE BLVD
MT. PLEASANT, MI 48858
EXIT: I 43 ON NORTH OR SOUTH US 127



2010 Joint Conference

MICHIGAN WATER ENVIRONMENT ASSOCIATION

PO Box 397, Bath, MI 48808

Phone: 517-641-7377

Fax: 517-641-7388

Email: mwea@mi-wea.org

